

D21 - 1617 LED NEON

OUTDOOR / EXTERIOR

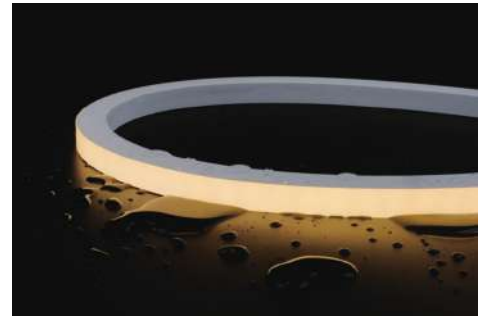

D21-1617 is a silicone co-extrusion IP67 neon that offers UV resistance, chemical stability, and protection against abrasion. It is freely configurable in length by cutting and capping with compatible endcaps.

- Made of DOW Chemical SILASTIC™ ET-7021 silicone rubber, which provides high transparency and high strength.
- Environmental protection grade silicone material with integrated extrusion molding process.
- Unique optical light distribution structure design, uniform lighting surface and no shadow.
- IP67 protection level, resistant to salts, acids, alkalis and UV.
- Excellent toughness, simple and stylish appearance, delicate and unique.
- 5 years warranty, working life > 50000 hours.



E507474

## Technical Data

<b>Dimension</b>	0.63in x 0.67in
<b>Voltage</b>	DC48V / DC24V
<b>RA</b>	>90
<b>Dimming</b>	Dimmable
<b>Efficacy</b>	81.8LM/W @4000K
<b>Storage Temp</b>	-40°C ~ 60°C
<b>Standard Length</b>	20m
<b>Max Length</b>	20m
<b>Warranty</b>	5 Years
<b>Watts / Meter</b>	10 Watts
<b>Color</b>	3K / 45K / Static Color / RGB / RGBW
<b>Standard Length Packing</b>	30M Rolls
<b>Max Length</b>	20M between 2pc Drivers

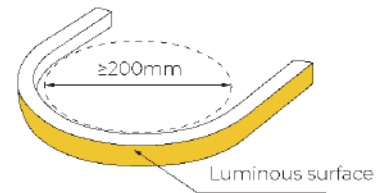

Min Bending diameter

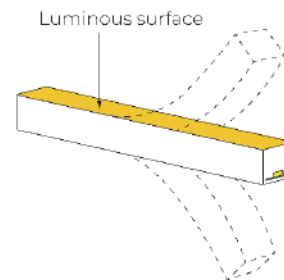

Bend vertical only

## Dimensions / Structure

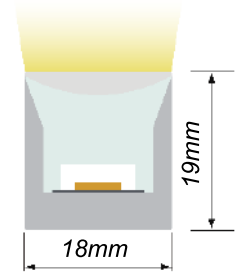
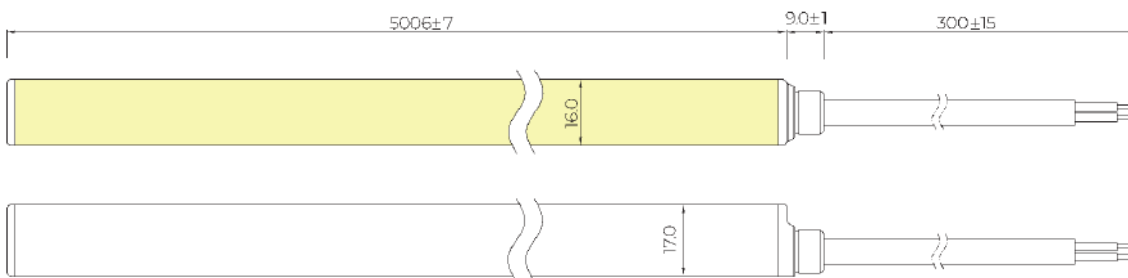

Cross section

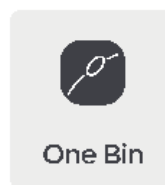
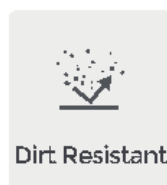

### Factory Connectors

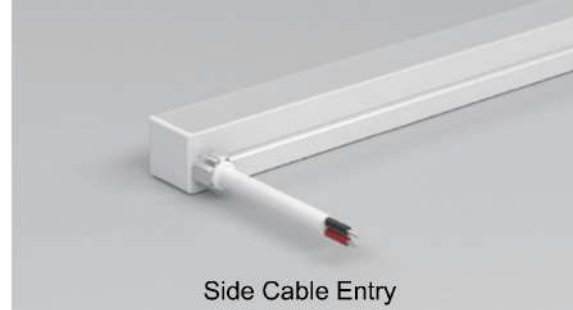
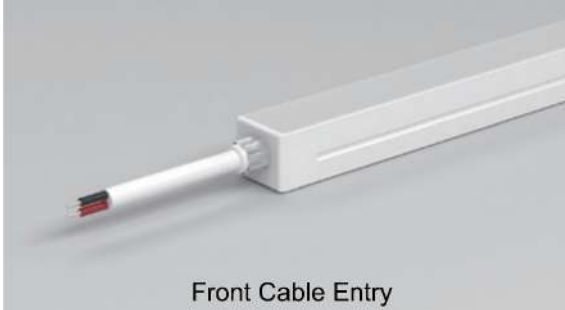

### DIY Solderless Connectors

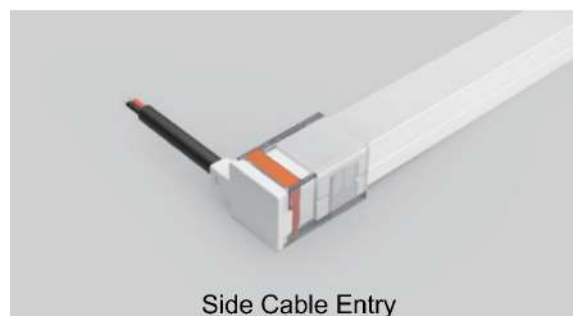
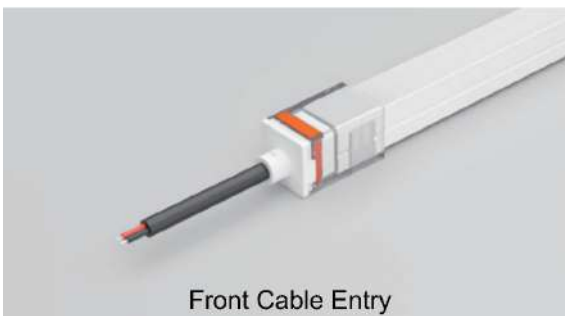

## Accessories

Aluminium Mounting clips

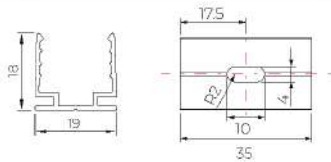

Length: 35X19X18

Accessories:

Screw M3X16 (SUS304)

PC Profile

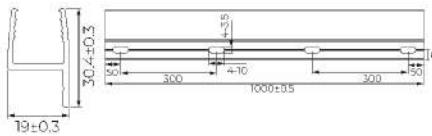

Length: 1000X19X30.4

Accessories:

Screw M3X16 (SUS304)

Aluminium Profile

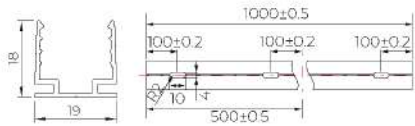

Length: 1000X19X18

Accessories:

Screw M3X16 (SUS304)

PC Profile

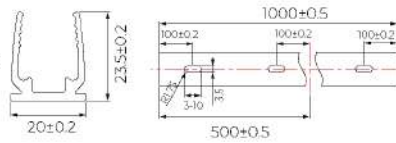

Length: 1000X20X23.5

Accessories:

Screw M3X16 (SUS304)

Internal Gear Profile

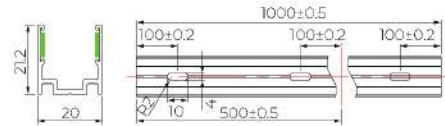

Length: 1000X20X21.2

Accessories:

Screw M3X16 (SUS304)

PC Clip

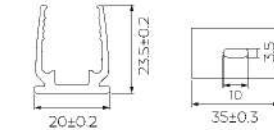

Length: 35X20X23.5

Accessories:

Screw M3X16 (SUS304)

IP67 Cross Connector

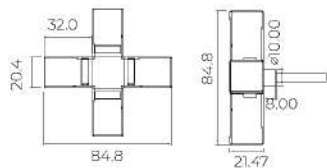

To connect 4pcs of neon after you cut it

IP67 Connector

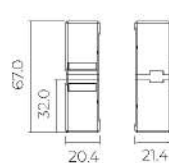

To connect 2pcs of neon after you cut it

Curved profile

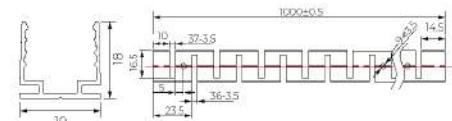
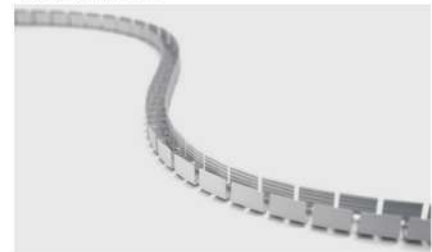

Length: 1000X19X18

Accessories:

Screw M3X16 (SUS304)

## Single Colour Connection

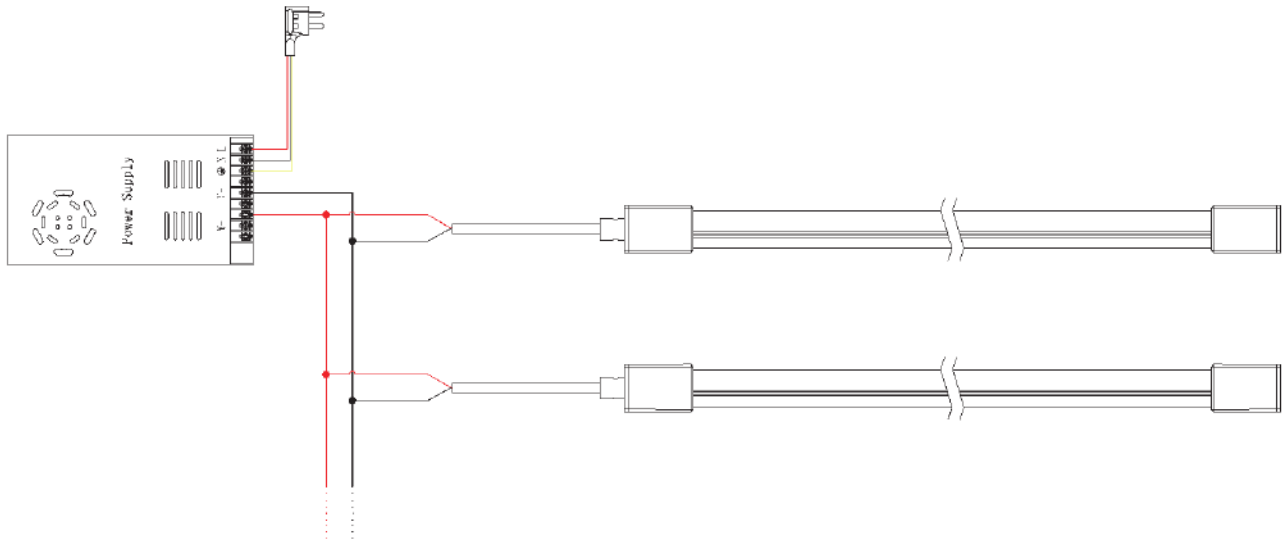

## Tunable White Connection

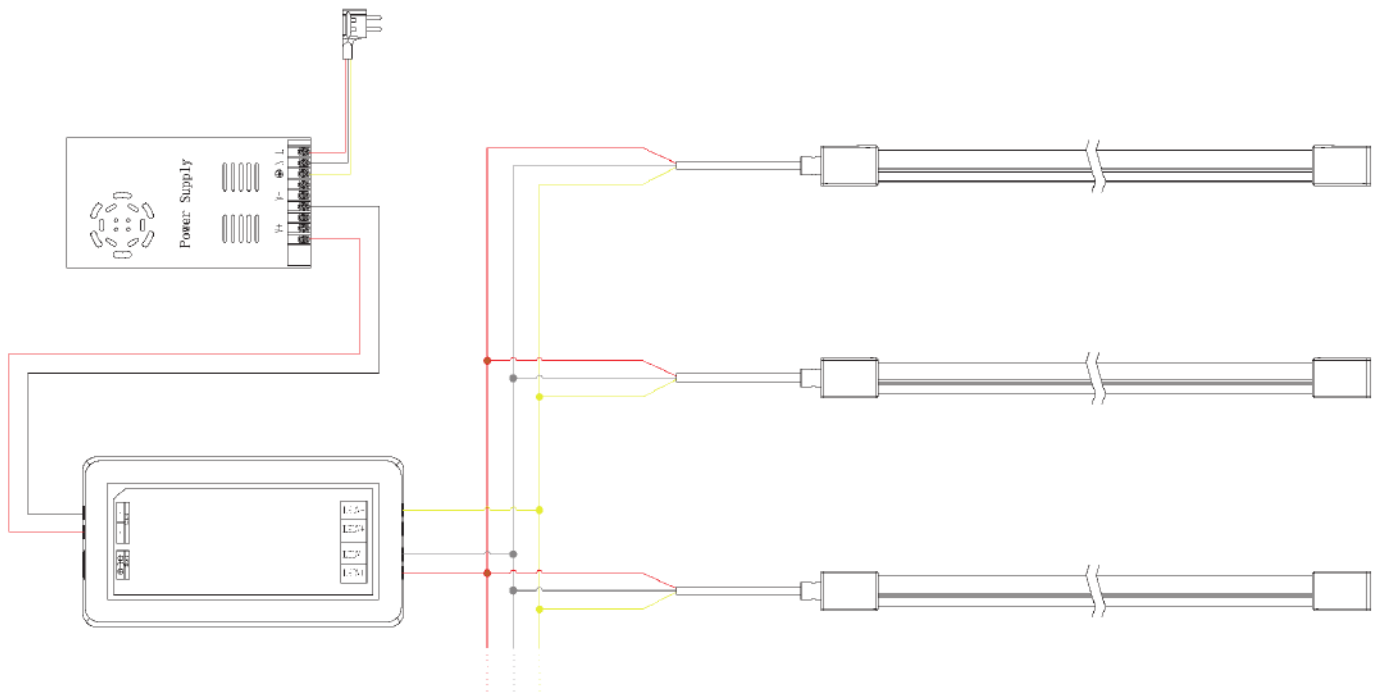

## RGB Connection

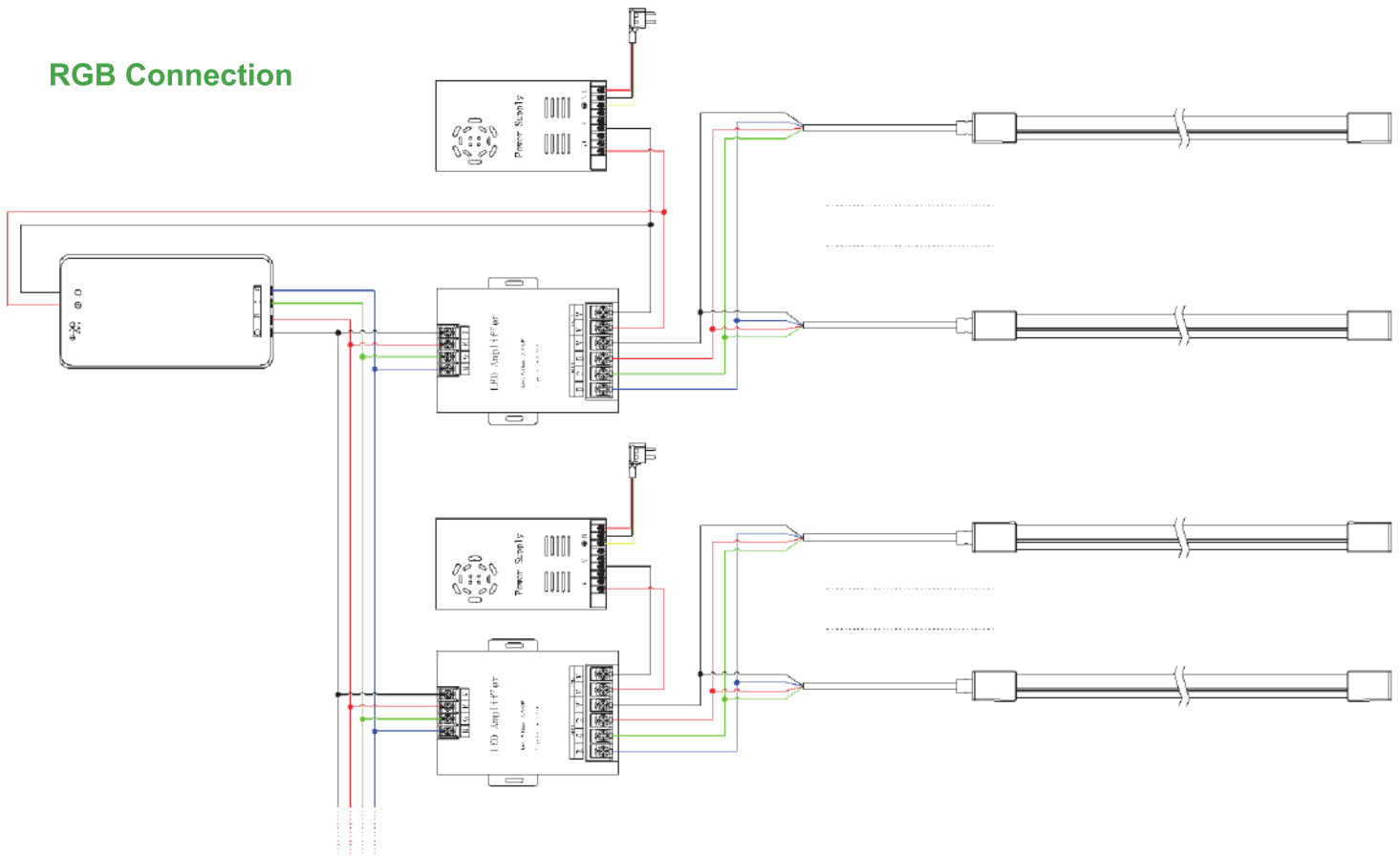

## RGBW Connection

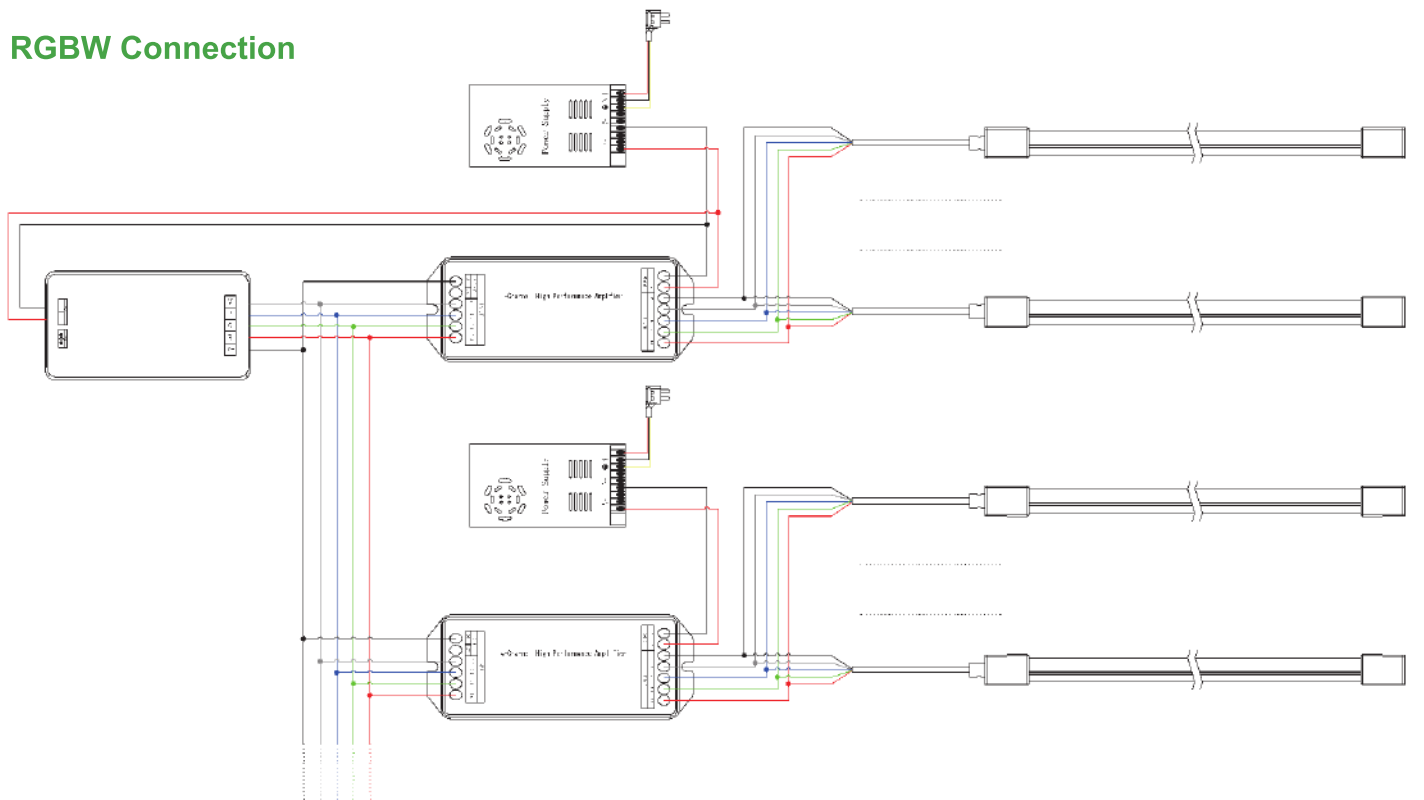

## Installation Precautions

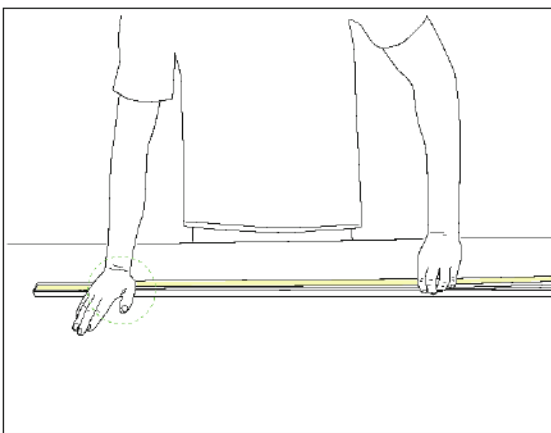
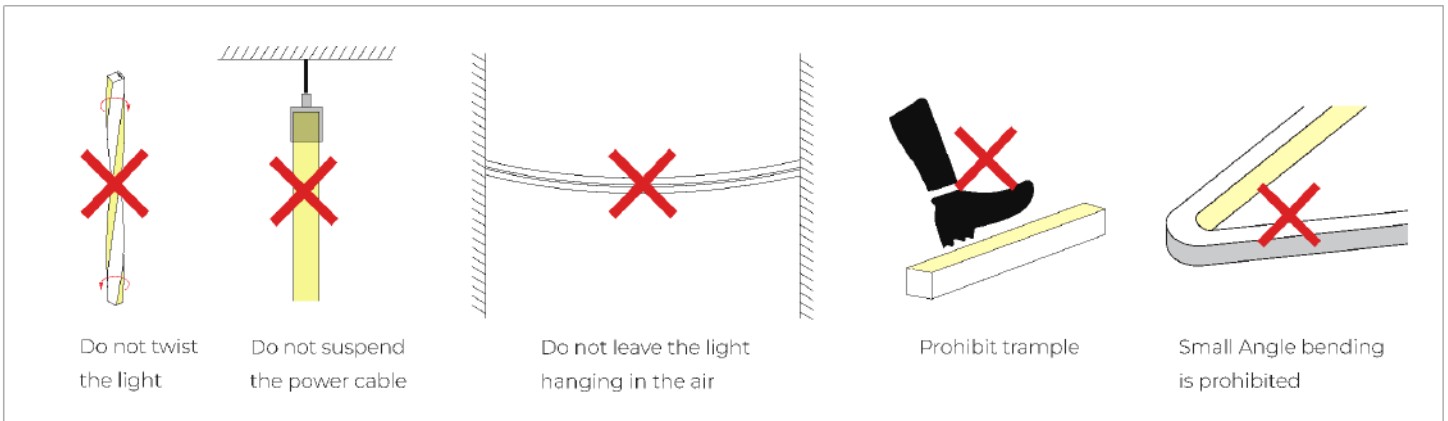
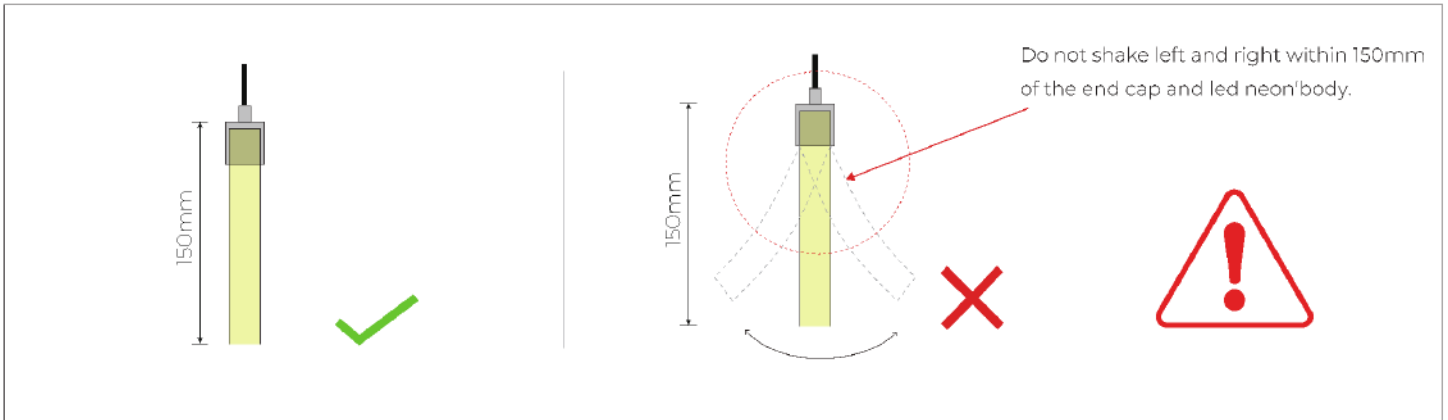

- Please press the led strip with your palm to slowly insert the led strip into the groove, and gently straighten the led strip above the groove with your right hand.
- Try to keep the led strip in a flat state during the installation process.

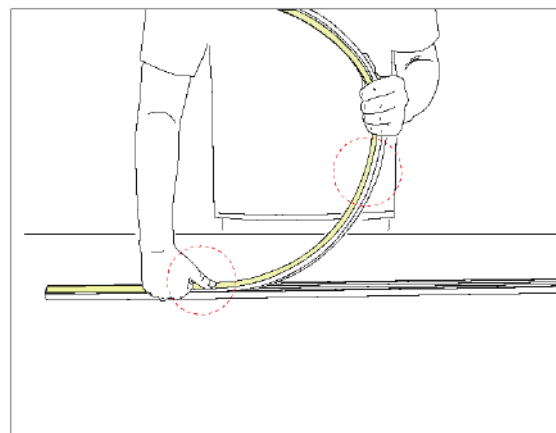

- Do not press the led strip with a single finger, it is easy to damage the internal parts of the led strip.
- The bent arc of the led strip should not be too large during installation.

## Installation Precautions

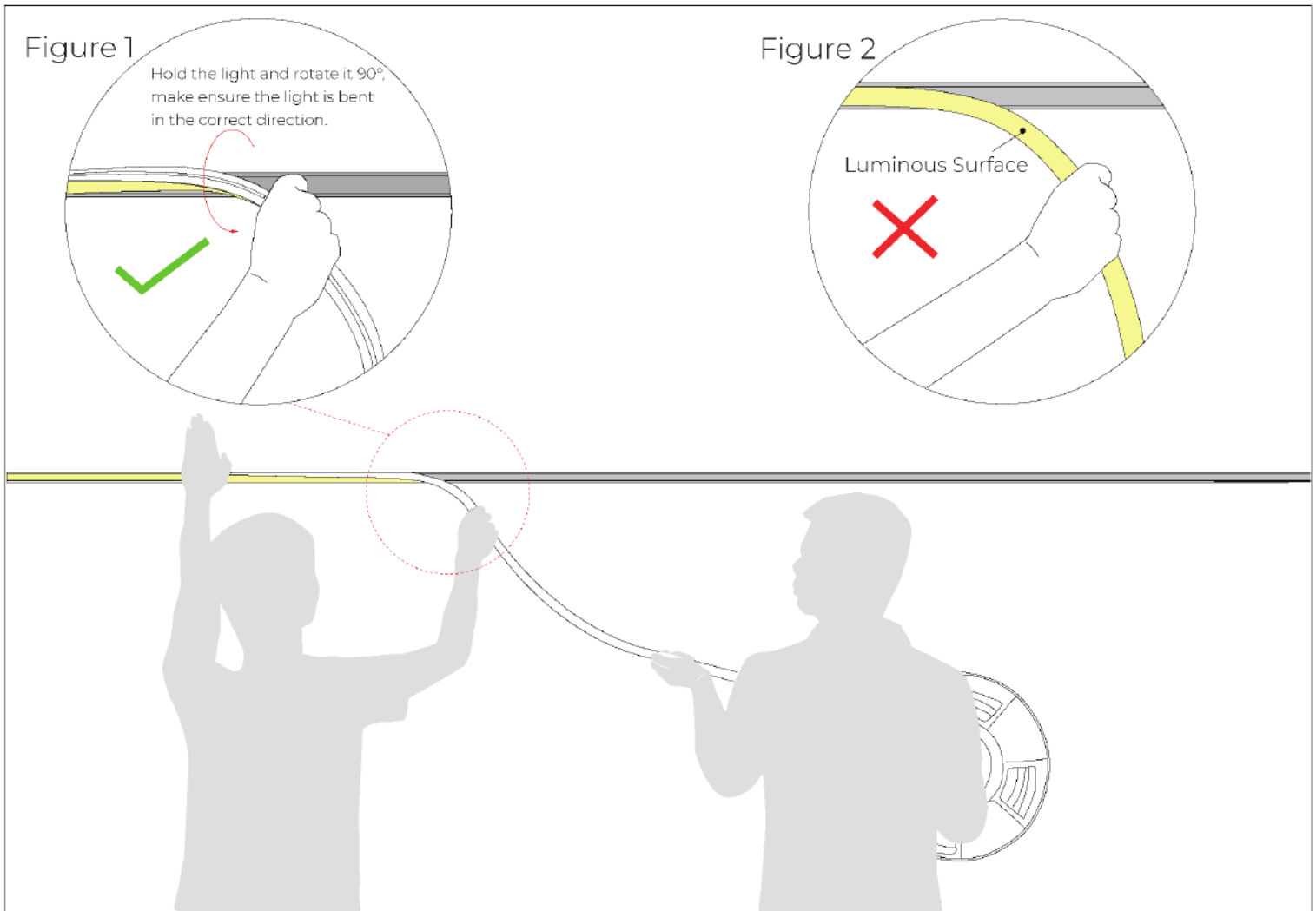

### 1.Installer:

- Press the light with the palm of the left hand to slowly load it into the slot. Straighten the light with right hand, hold it and rotate it 90 ° to droop it in the direction of your hand. See Figure 1.
- Do not bend the luminous surface to the side. See Figure 2.

### 2.Assistant:

- Cooperate with the installer to lift the reel of the light, and then slowly deliver the light to installer. Do not pull or twist the light during the installation.

## Installation Precautions

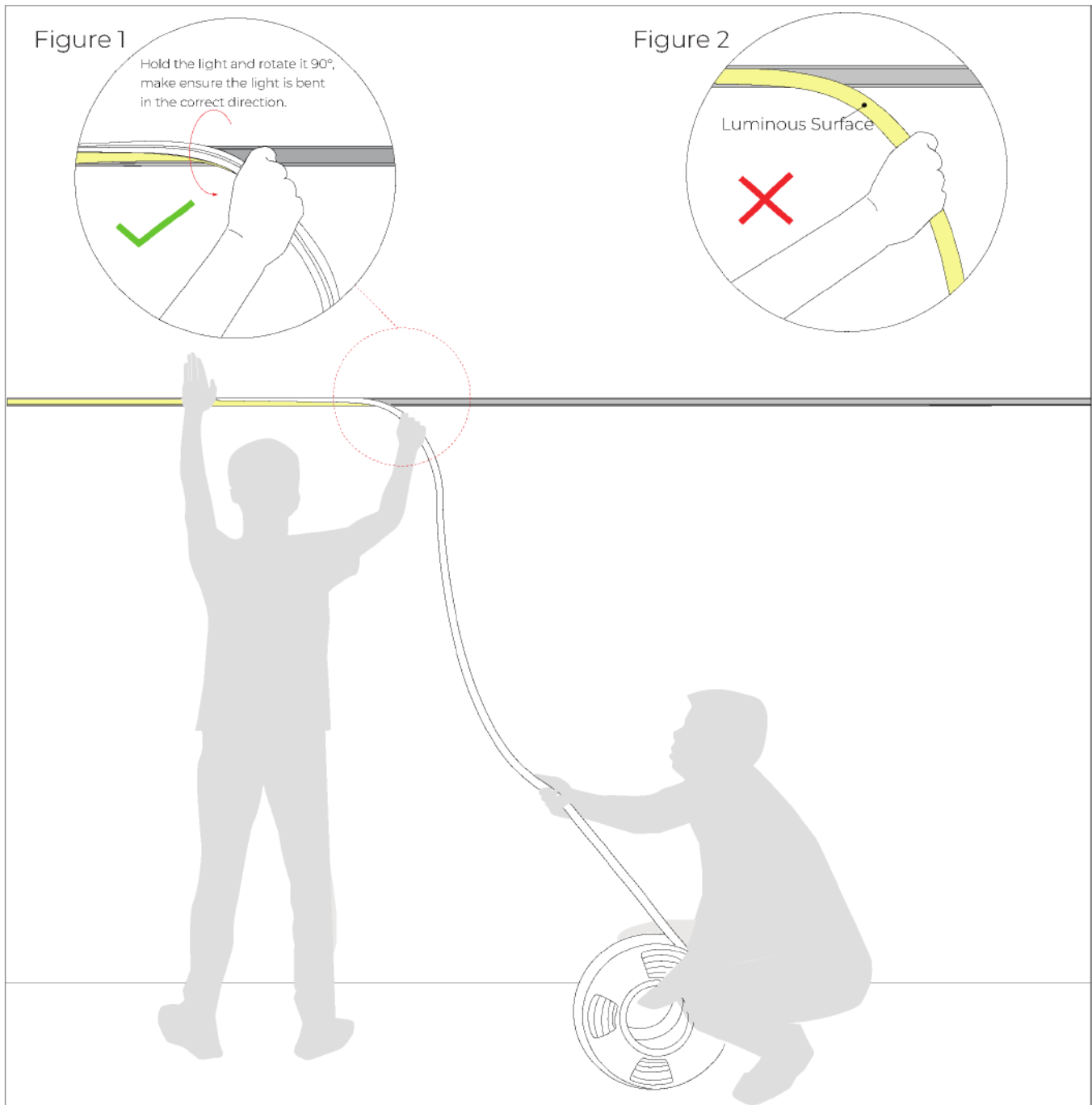

### 1.Installer:

- Press the light with the palm of the left hand to slowly load it into the slot. Straighten the light with right hand, hold it and rotate it 90 ° to droop it in the direction of your hand. See Figure 1.
- Do not bend the luminous surface to the side. See Figure 2.

### 2.Assistant:

- Cooperate with the installer to slowly deliver the light to installer. Do not pull or twist the light during the installation.

## Installation Precautions

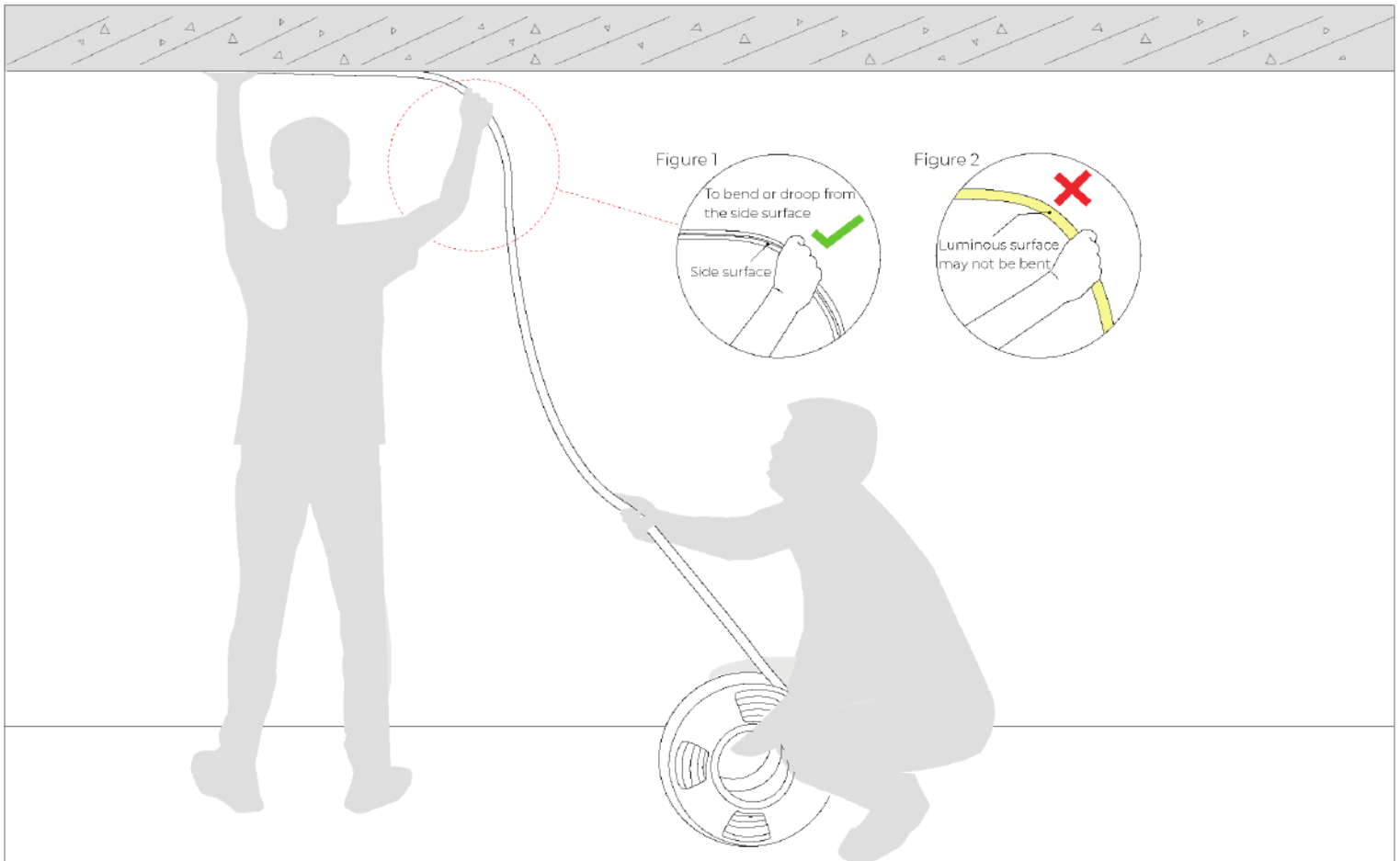

### 1.Installer:

- Press the light with the palm of the left hand to slowly load it into the slot. Straighten the light with your right hand so that it droop naturally. See Figure 1.
- Luminous surface may not be bent. See Figure 2.

### 2.Assistant:

- Cooperate with the installer to slowly deliver the light to installer. Do not pull or twist the light during the installation.

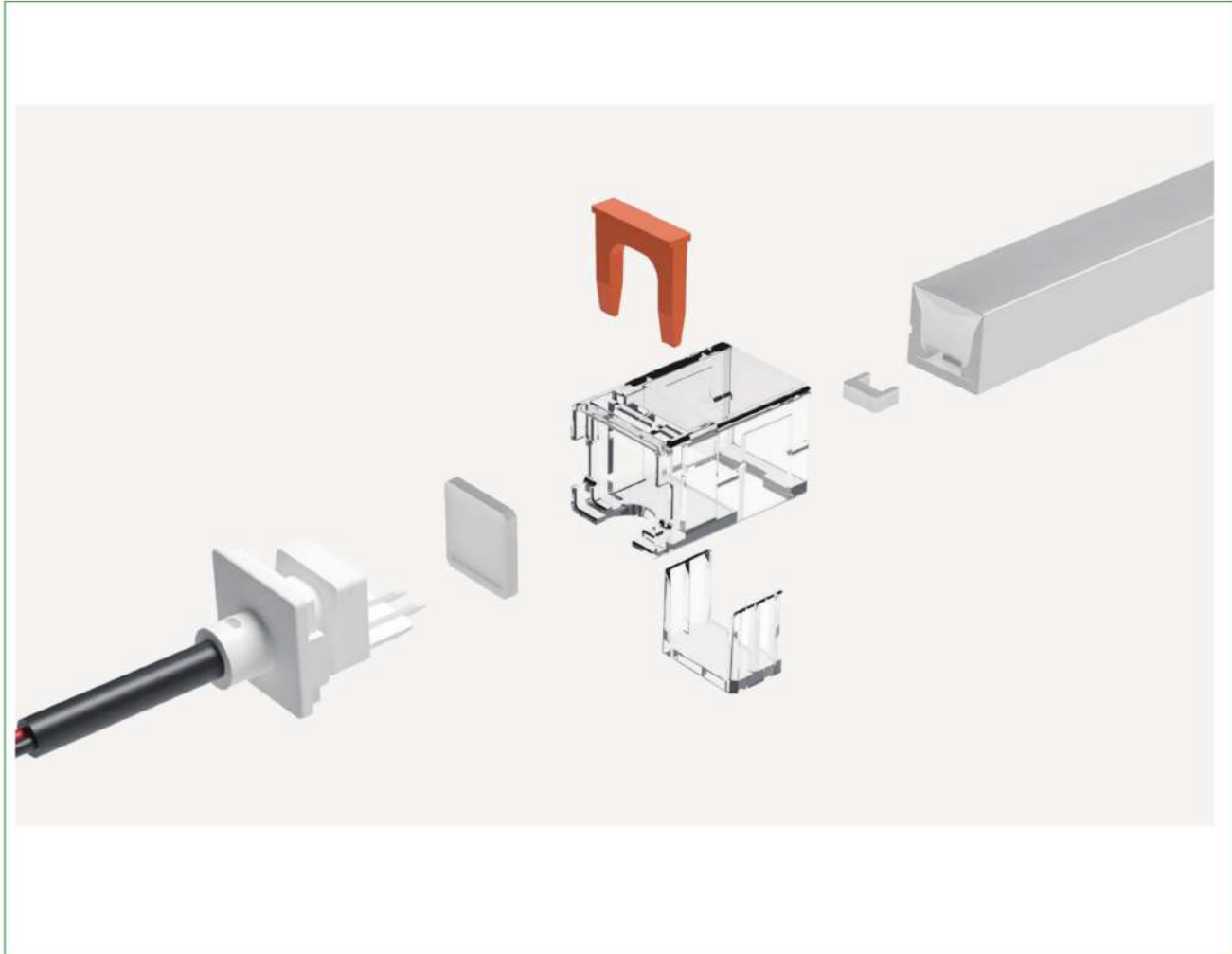

## Solderless Power Feed IP67

---